

THE MAIDSTONE BOROUGH COUNCIL

TOWN AND COUNTRY PLANNING (GENERAL PERMITTED  
DEVELOPMENT) ORDER 1995

DIRECTION MADE UNDER ARTICLE 4(1) TO WHICH  
ARTICLE 5(4) APPLIES

LAND TO THE SOUTH EAST OF MAIDSTONE ROAD. NETTLESTEAD,  
KENT

**WHEREAS** the Council of the Borough of Maidstone being the appropriate local planning authority within the meaning of article 4(6) of the Town and Country Planning (General Permitted Development) Order 1995, are satisfied that it is expedient that development of the description(s) set out in the Schedule below should not be carried out on land shown edged red on the attached plan, unless permission is granted on an application made under Part III of the Town and Country Planning Act 1990.

**AND WHEREAS** the Council consider that development of the said description(s) would be prejudicial to the proper planning of their area and would constitute a threat to the amenities of their area and that the provisions of paragraph 4 of article 5 of the Town and Country Planning (General Permitted Development) Order 1995 apply,

**NOW THEREFORE** the said Council in pursuance of the power conferred on them by article 4(1) of the Town and Country Planning (General Permitted Development) Order 1995 hereby direct that the permission granted by article 3 of the said Order shall not apply to development on the said land of the description(s) set out in the Schedule below.

**THIS DIRECTION** is made under article 4(1) of the said Order and, in accordance with article 5(4) shall remain in force until 27 October 2001 (being six months from the date of this Direction) and shall then expire unless it has been approved by the Secretary of State for the Environment, Transport and the Regions.

**SCHEDULE**

1. The erection, construction, maintenance, improvement or alteration of a gate, fence, wall or other means of enclosure, being development comprised within Class A of Part 2 of Schedule to the said Order;

and not being development comprised within any other class.

Given under the Common Seal of the **MAIDSTONE BOROUGH COUNCIL** this  
27 day of April 2001.

The Common Seal of the Council )  
 )  
was affixed to this Direction in the )  
 )  
presence of:- )

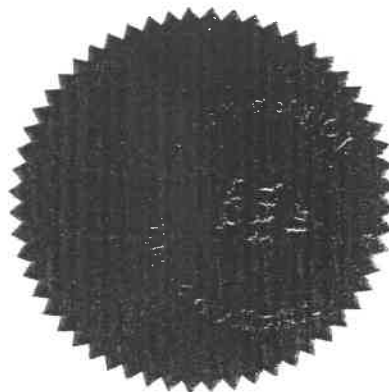

R88278/1

Handwritten signature of S. P. Ash

Solicitor - Authorised Signatory

# THE MAIDSTONE BOROUGH COUNCIL

## PROPOSED ARTICLE 4 DIRECTION

LAND TO THE SOUTH - EAST OF MAIDSTONE ROAD, NETTLESTEAD

GRID REF: 6761-4995

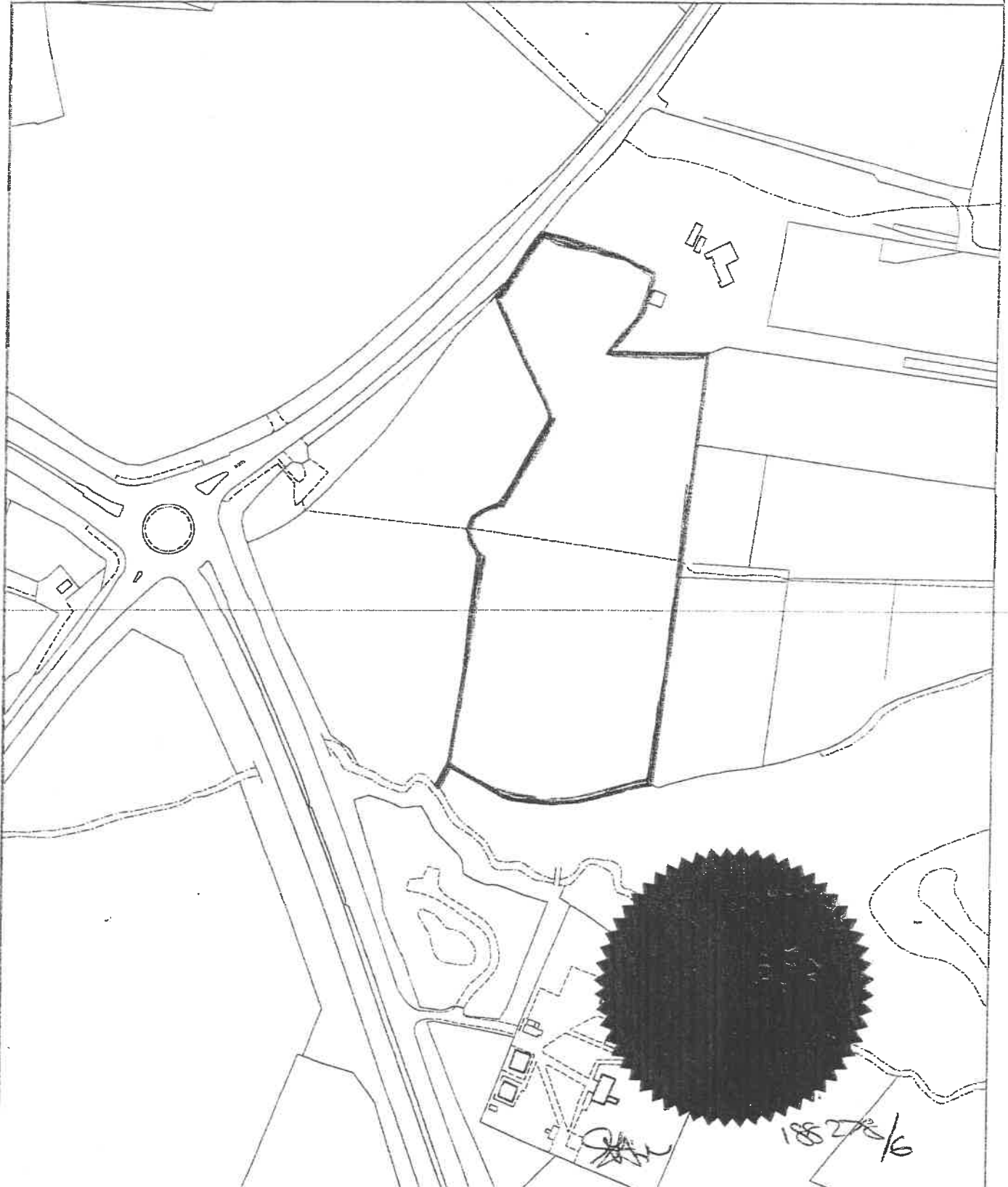

Reproduced from the Ordnance Survey mapping with the permission of the Controller of Her Majesty's Stationery Office © Crown copyright. Unauthorised reproduction infringes Crown copyright and may lead to prosecution or civil proceedings. The Maidstone Borough Council Licence No. 078484, 2000. Scale 1 : 2500



**Trevor Gasson BA(Hons), MRTPI, MIMgt**  
**Director of Development Services**  
**Deputy Chief Executive**